

 Never turn on any equipment when there is an evidence of fire, water or structural damage

 xStorage Home must be installed only by a qualified personnel i.e. Eaton’s certified installer

 During installation unplug xStorage Home. Read and understand safety warnings prior to installation

Preparation phase

Instructions

- Both packed hybrid inverter and battery pack units are considerably heavy: wear safety shoes and preferentially use a vacuum lifter for handling operations
- All handling operations will require at least two people (unpacking, lifting, installation i.e. mounting on the indoor wall).
- Select a suitable indoor mounting location such as the house or the garage, no drywall and no outdoor mounting allowed. Operational temperature range: [-10°C, 30°C], 5% to 95% relative humidity (non condensing)
- Due to the various wall types, fixing the xStorage Home system might differ from case to case: Contact your Eaton technical support representative for recommendations

- In case of missing accessories, contact your Eaton technical support representative
- xStorage Home parts MUST NOT be energised during mounting and installation
- Allocate a minimum wall area of 1530 x 1190 mm that is clear of all electrical wiring, pipework or other obstructions either on or buried within the wall
- Use appropriate tools for installation

Packaging: xStorage Home & accessories

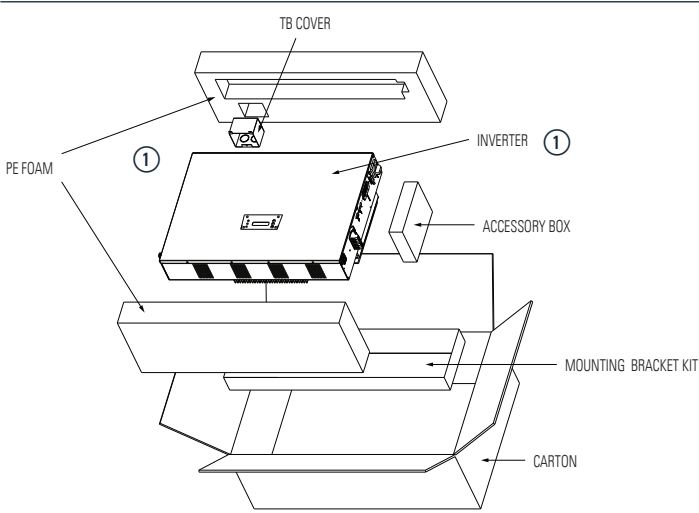

No.	Invertor accessory
1	1x hybrid inverter unit, dim: 796 x 515 x 182 mm (W x H x D)
2	1x wall mounting bracket
3	8x M5*40mm round thick head wall mounting screws for BT type
4	8x plastic wall insert plug (M5) type
5	3x M4*15mm truss cross
6	3x M3*8mm round washer head screw, machine type
7	16x M4*6mm flat cross
8	1x blanking/cover panel for MC4 connector (Connected and disconnected)
9	1x RS232 communication cable
10	1x grounding wire
11	1x terminal block cover for AC load output and input
12	1x Quick Start Guide, 1x Safety Guidelines
13	1x wifi dongle
14	1x terminal block

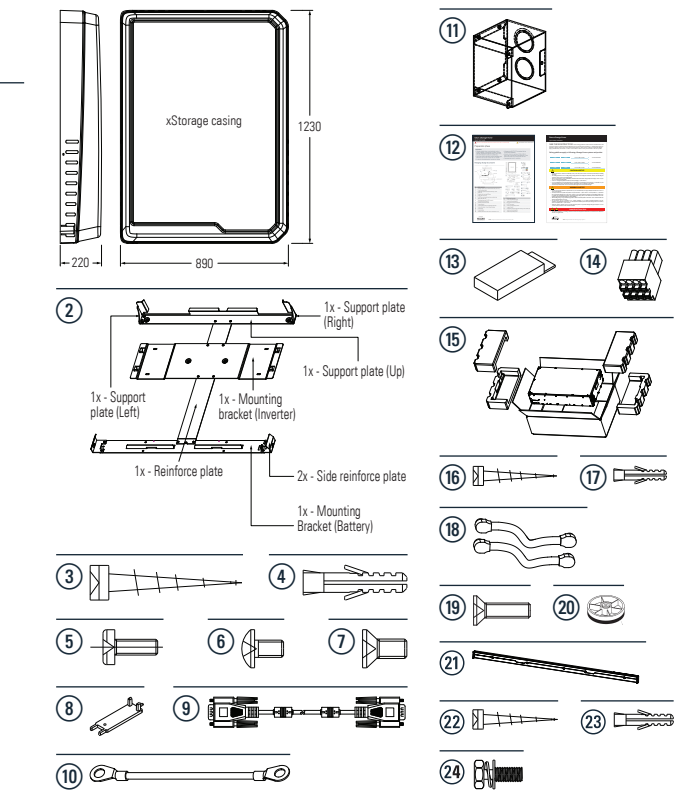

No.	Battery pack accessory
15	1x battery pack unit, dim: 781 x 442 x 175 mm (W x H x D)
16	1x wall mount M4*30mm screw
17	1x plastic wall insert plug (M4)
18	Power cords for DC input connections
19	5x M5*10mm screws
20	1x foot for leveling battery position
21	1x support bracket
22	7x M5*40mm round thick head wall mounting screws for BT type
23	7x plastic wall insert plug (M5)
24	1x M6*12mm grounding screw

Mounting

Instructions

- To meet warranty and safety requirements, keep the distance between the xStorage Home system casing and surrounding sides at minimum of 15cm
- Wall must support following weights: 37kg inverter, 83kg battery pack, casing and mounting bracket appr. 15kg. Total of 135kg
- Mount the inverter and battery pack onto wall bracket (the user may install screw to secure the battery pack on the wall mounting bracket)

- Mount the casing onto wall bracket (the user may install screw to secure the outside cover on the wall mounting bracket)
- Once installed, the xStorage Home system must not be opened under any circumstances. In case of need, contact your installer
- Note:** the torque to tighten mounting screws should not be higher than the 0.4Nm

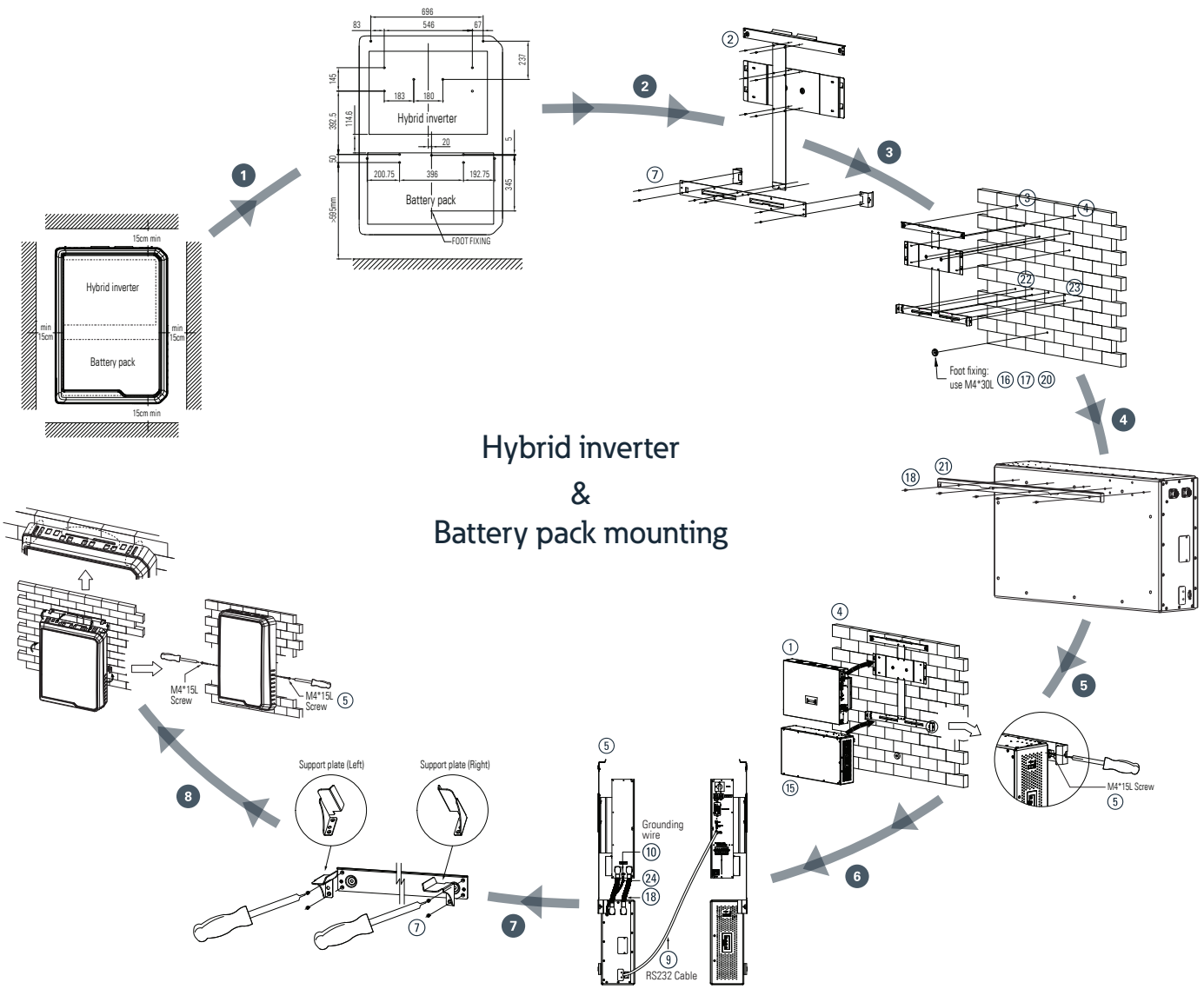

Wiring

Hybrid inverter connections

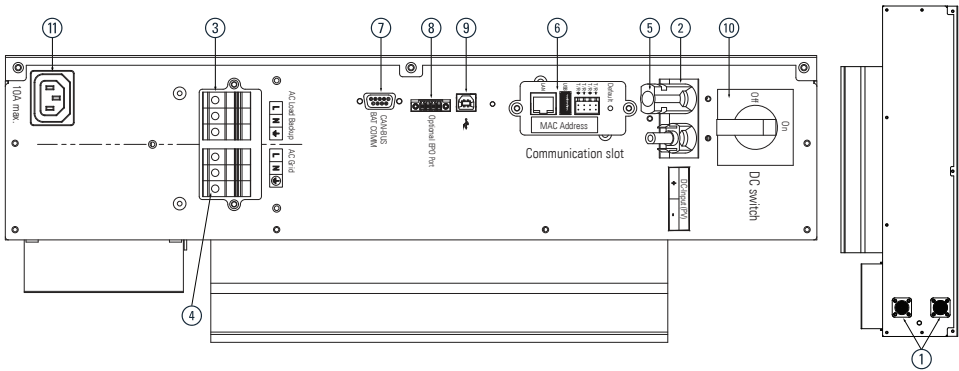

Battery pack connections

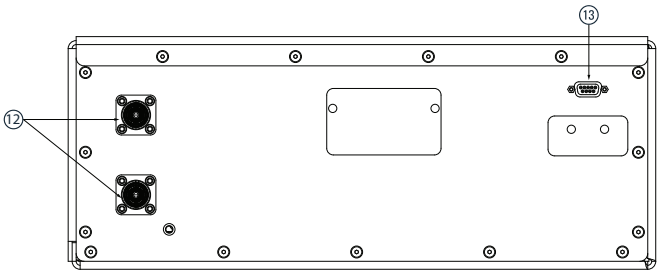

System connection diagram

Cable Selection

- Connect both AC grid / AC distribution box with 10AWG / 4mm² cable size (preferred)

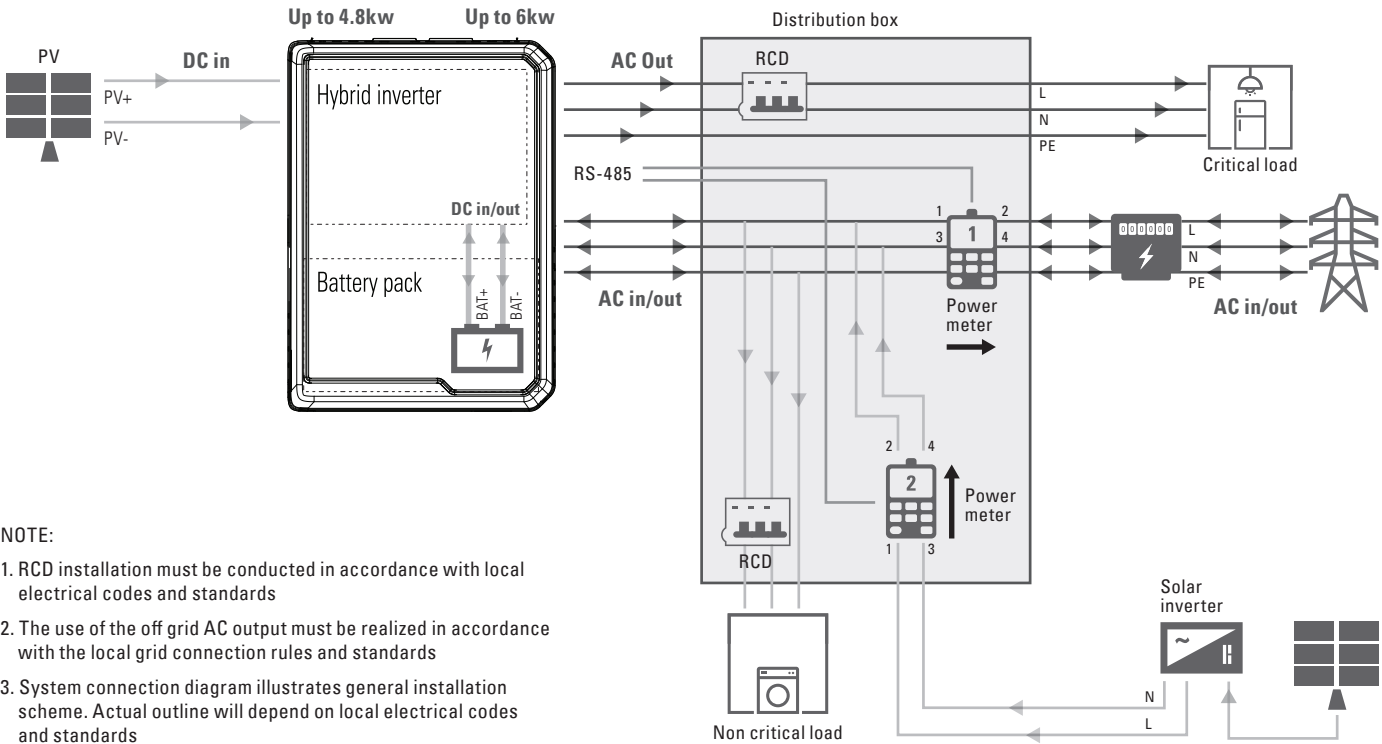

- NOTE:
- RCD installation must be conducted in accordance with local electrical codes and standards
 - The use of the off grid AC output must be realized in accordance with the local grid connection rules and standards
 - System connection diagram illustrates general installation scheme. Actual outline will depend on local electrical codes and standards

AC load output/input

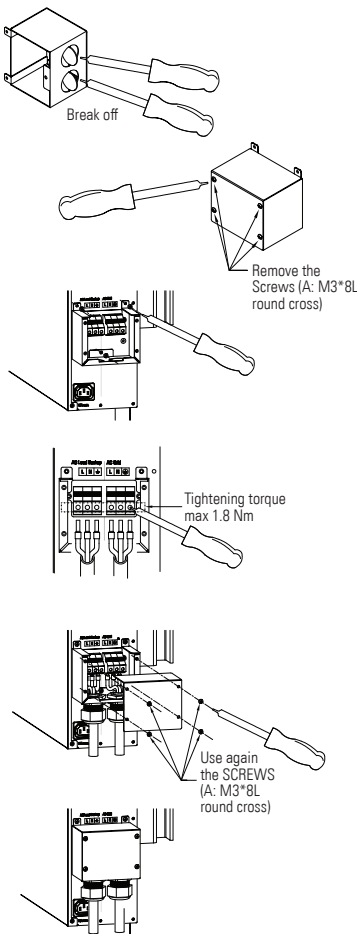

Connection reference	Description
1	DC-Input (BAT): Amphenol terminals for battery pack connection
2	DC-Input (PV): Cable cross section must be calculated according to Isc
3	AC Load-Output: The terminal supports the AC power wires connection. L (Phase), N (Neutral), GND (PE): Ø 4/6mm ²
4	AC Grid-Input: The terminal supports the AC power wires connection. L (Phase), N (Neutral), GND (PE): Ø 4/6mm ²
5	Ground (PE) Screw: Accessory include GND wire (Ø 10mm ²) to connect battery pack chassis for safety purpose
6	Communication Slot: Ethernet card already assembled; LAN, USB and RS-485 port
7	CAN-BUS BAT COMM: Accessory includes RS232 cable to communicate with BMS board
8	Optional EPO port
9	USB
10	DC switch disconnecter
11	AC plug limited to 10A load output
12	DC-Input (BAT): Amphenol terminals for hybrid convertor connection
13	CAN-BUS BAT COMM: Accessory includes RS232 cable

Network configuration

Setting the Ethernet card for the first time

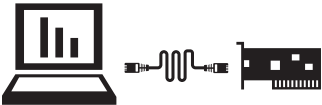
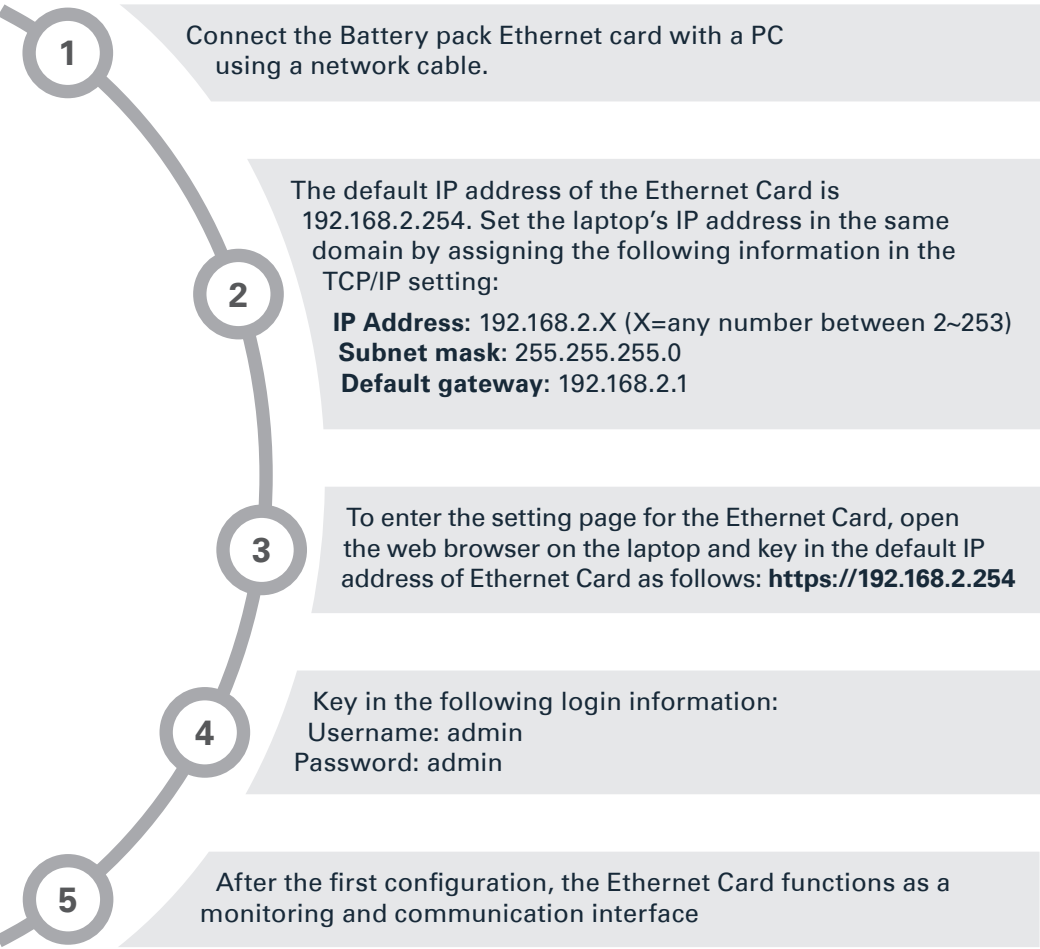

Please Sign In

admin

.....

Submit

TECHNICAL DISCLAIMER: All drawings, specifications, any descriptions or illustrations contained in this document are issued or published by Eaton for the sole purpose of giving an approximate idea of the supplies described in them. They will not form part under these Terms in general or this Warranty specifically and might be subject to technical changes in the future.